

## Ultima Passive Tap

Model Series UPT



The **ULTIMA** Passive Tap (UPT series) tap is built on the same proven 9 inch platform as the Electroline addressable tap. It provides unprecedented flexibility for managing signal levels being delivered to and received from the subscriber's premises.

The **ULTIMA** has, built into the housing, power and RF bypass that maintains signal continuity to downstream subscribers during servicing of the tap.

The **ULTIMA** tap is designed with interactive, multimedia, and cable modem services in mind. There are a variety of optional plug-in modules that provide the facilities for system designers to condition the forward and return path signal levels, path loss and slope. To optimize the operational performance of the return system amplifiers, optical nodes, cable modems, and CMTS, it is a benefit to have equal path loss between each cable modem and the first upstream amplifier and/or optical transmitter. In the real world, it is not practical to achieve "equal" return path loss but the **ULTIMA** tap's optional broadband equalizer provides system designers with the tools to optimize system performance.

The plug-in directional couplers provide the convenience in minimizing the inventory of spares and the ability to reconfigure a tap without having to change out the entire base plate. Additionally

### Features:

- Same 9 inch housing as Electroline's proven Addressable Tap.
- RF and Power Bypass when base plate is removed.
- Plug-in, reversible Directional Coupler
- Weather proof
- 15 Amp power passing
- Available in 2, 4 and 8 subscriber port versions
- SCTE compliant 360° contact connectors
- Color-coded tap values
- Return path loss management
- Plug-in broadband equalizer modules
- Pedestal or aerial mounting
- Optional wall mount bracket

there is no need to have one spare of each value of tap in the service tech's truck. If a tap base plate is damaged, the directional coupler from the damaged tap can be plugged into the new replacement base plate. This eliminates the chances that an inappropriate tap value would be installed just because he didn't have the correct value base plate in the truck.

Although in most applications this tap would be installed on the strand, it can be configured for pedestal, cabinet or wall mounting.

# General Specifications

ELECTRICAL	
Bandwidth	5 to 1003 MHz
Continuous Thru Current	15 amps
Hum Modulation (dB)	
5 MHz to 10 MHz	50
>10 MHz to 50 MHz	60
>50 MHz to 750 MHz	70
>750 MHz to 1GHz	60
Return Loss (dB)	
Through port	16 (10 - 1000MHz)
Tap port	18 (10 - 1000MHz)
Tap to Tap Isolation (dB)	25
Tap to out Isolation	Note 1
Tap loss	Note 1
Through loss	Note 1
Impedance	75 ohms
Surge protection	IEEE C62.41-1991 cat B3 Combo Wave (Thru ports) IEEE C62.41-1991 cat A3 Ring wave (Thru and Subscriber ports)
Plug-in coupler values available:	0,4,7,10,13,16,19,22
Tap Values Available (dB loss input to tap)	
2 way	4,8,11,14,17,20,23,26
4 way	8,11,14,17,20,23,26,29
8 way	11,14,17,20,23,26,29

MECHANICAL	
	<ul style="list-style-type: none"> <li>AL 360T housing with coating for environmental protection</li> <li>Double sealed and swaged extended F-ports for maximum resistance to moisture ingress</li> <li>Nickel-plated brass F-ports for maximum corrosion-resistance on drop interface</li> <li>Versatile housing design permits aerial, pedestal, or MDU mounting schemes</li> </ul>
Pressure tested	10 psi for 6 hours under water
EMI shielding (minimum)	120 dB
Operating temperature	-40°C to + 60°C (-40°F to +140°F)
Dimensions	9.5 L x 3.54 W x 3.37 H inches 241.3 L x 90 W x 85.6 H mm
Weight	1.22kg 2.7 lbs

## Note

1 - Varied by value of tap. Request for the Specification document for more detailed parameters suitable for system design

2 - Specifications are subject to change without notice

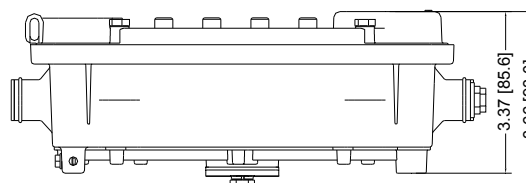
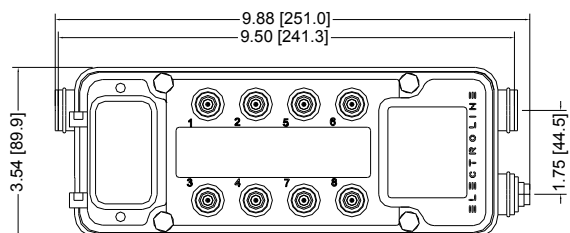

**Corporate Headquarters**  
Electroline Equipment Inc.  
11035 Louis-H. Lafontaine  
Anjou, Québec Canada H1J 3A3

**Telephone**  
North America (800) 461-3344  
Elsewhere (514) 374-6335

**Fax**  
Corporate / Ordering:  
(514) 374-2257

**General Inquiries**  
[info@electroline.com](mailto:info@electroline.com)  
**Technical Support**  
[support@electroline.com](mailto:support@electroline.com)